

Olsbergs

MultiDrive

Controller Cable 4F



Technical description



English

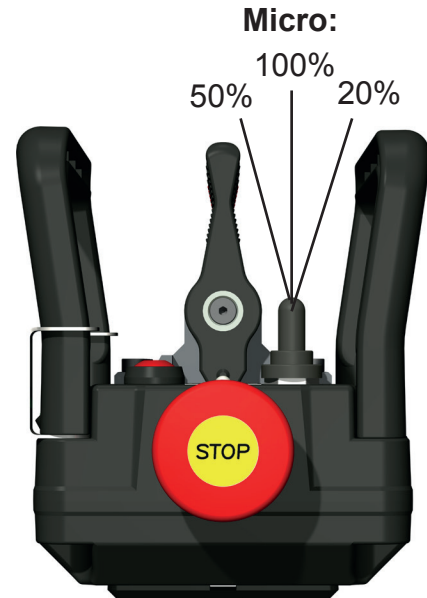

Controller 4F for remote control via cable

The controller 4F is a small and robust device that communicates via CAN cable with a data transfer rate of 50kBit/s. It is designed for secure and precise manouvering. The circuit boards in the controller have a special treatment in order to withstand tough operation environment and conditions.

Operator friendly user interface

All four lever/functions are exact proportional and the different functions move according to the angles of the activated levers. The controller is designed to control Olsbergs hydraulic valves.

Menus

The controller have a menu system with four different menus. The levers can have the same or different functions in different menus. However one function can only be operated by one specific lever. A distinct LED indicates which menu is activated. In addition there are four push buttons for on/off functions of which one is designated for the horn and the rest for e.g. start, stop and rpm.

Micro control

By activating the toggle switch for micro the resolution on all levers on the controller can be changed for operation with higher precision. It is possible to choose 50% or 20% of normal speed. This is very useful in narrow passages or when gentle movements are required.

Function

Lever data is translated to a CAN protocol that is transferred via CAN cables to digital amplifiers, DA modules which are connected on the positioners, actuators, on the hydraulic valve. The DA modules convert the data to pulse width modulated currency that via the solenoid in each positioners controls the valve spools and thereby the different functions. The controller communicates also with the overall safety system if there is one available.

Safety

The hand controller can be locked to prevent unauthorised persons, such as children, from starting the controller and being able to operating the application.

The system is CE-marked and approved in accordance with machinery directive 2006/42/EG.

Controller Cable 4F MD K

Spare parts

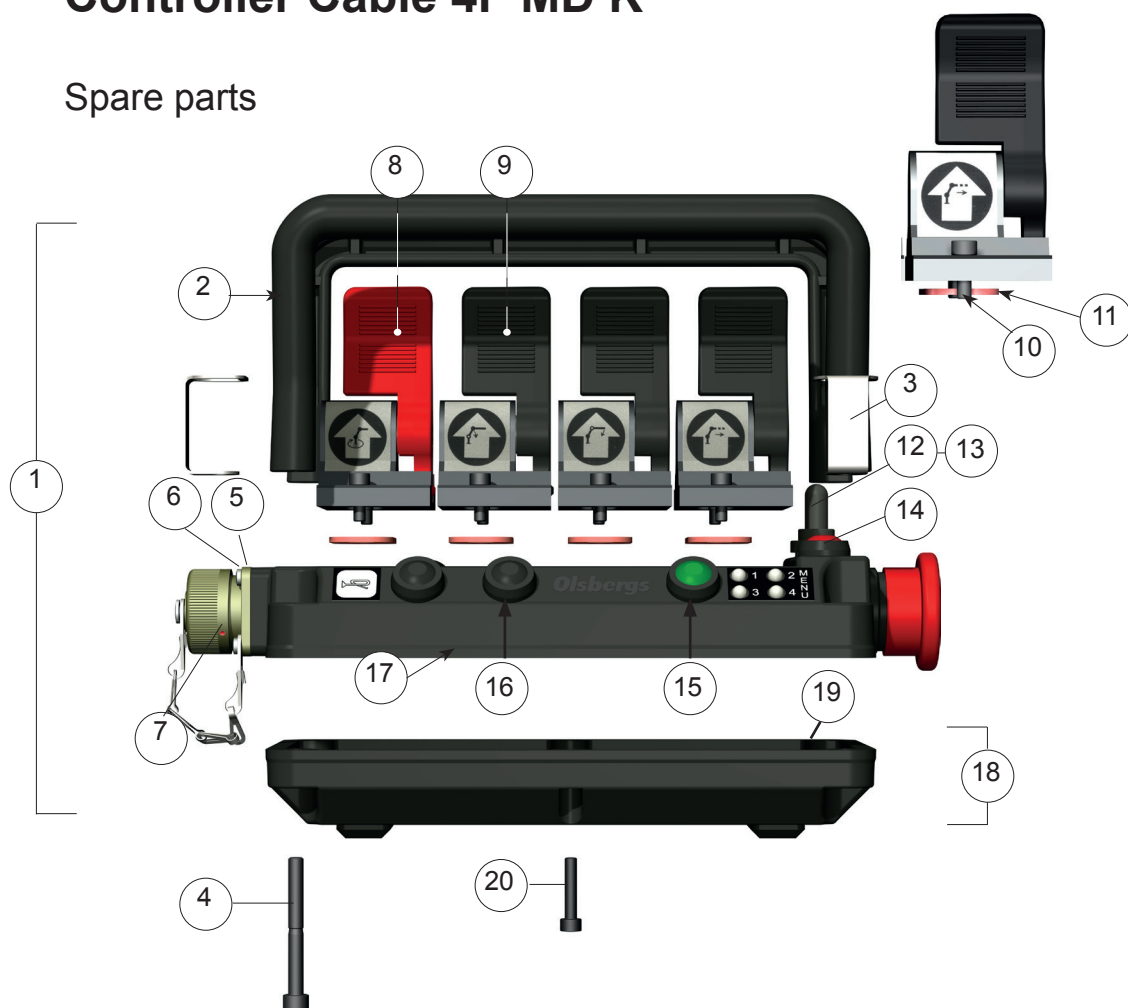

Pos	Part. N°	Description	Note
1	1211K	Controller Cable 4F MD K	
2	E0996	Arch, controller 4F MD	incl. fittings
3	E0461	Attachment carrier strap MD	
4	S0238	Screw MC6S M5x45	Black nickel plated
5	S2813	Contact chassis	
6	S2654	Screw TPPT T30x10 A2	
7	S2818	Cap, controller MD	
8	0499	Lever, red	incl. screw and gasket
9	0498	Lever, black	incl. screw and gasket
10	S0081	Screw MC6S M4x12	A4-70 black nickel plated
11	E0447	Gasket 44,6, 4x2 Silicone red	
12	S1618	Toggle switch, tri-state	
13	S1620	Rubber cover	
14	S2416	Push button, red	
15	S2418	Push button, green	
16	S2414	Push button, black	
17	E1114K	Top box, controller cable 4F MD K	excluding arch, fittings and levers
18	E1113	Bottom box, controller 4F MD	
19	S2803	O-ring Ø180,0x3,0 NBR 70	
20	S1776	Screw MC6S FT M4x20 A4-70	Black nickel plated
		Cables	
	E1128	CAN cable 15,24 m	
	E1130	CAN cable adaptor 1 m alternatively	
	E1136	CAN cable adaptor 3 m	
	0020	Carrier strap	

Olsbergs Electronics AB
Box 267
SE-186 24 VALLENTUNA, Sweden
Phone: +46 (0)8-511 858 50
E-mail: electronics@olsbergs.se

Olsbergs Hydraulics AB
Box 17
SE-575 21 EKSJÖ, Sweden
Phone: +46 (0)381-150 75
Fax: +46 (0)381-140 71
E-mail: hydraulics@olsbergs.se