

Seal kit in- and outlet section

Fits: All in- and outlet sections for Pv90

Consumption: 1 kit per in- or outlet section

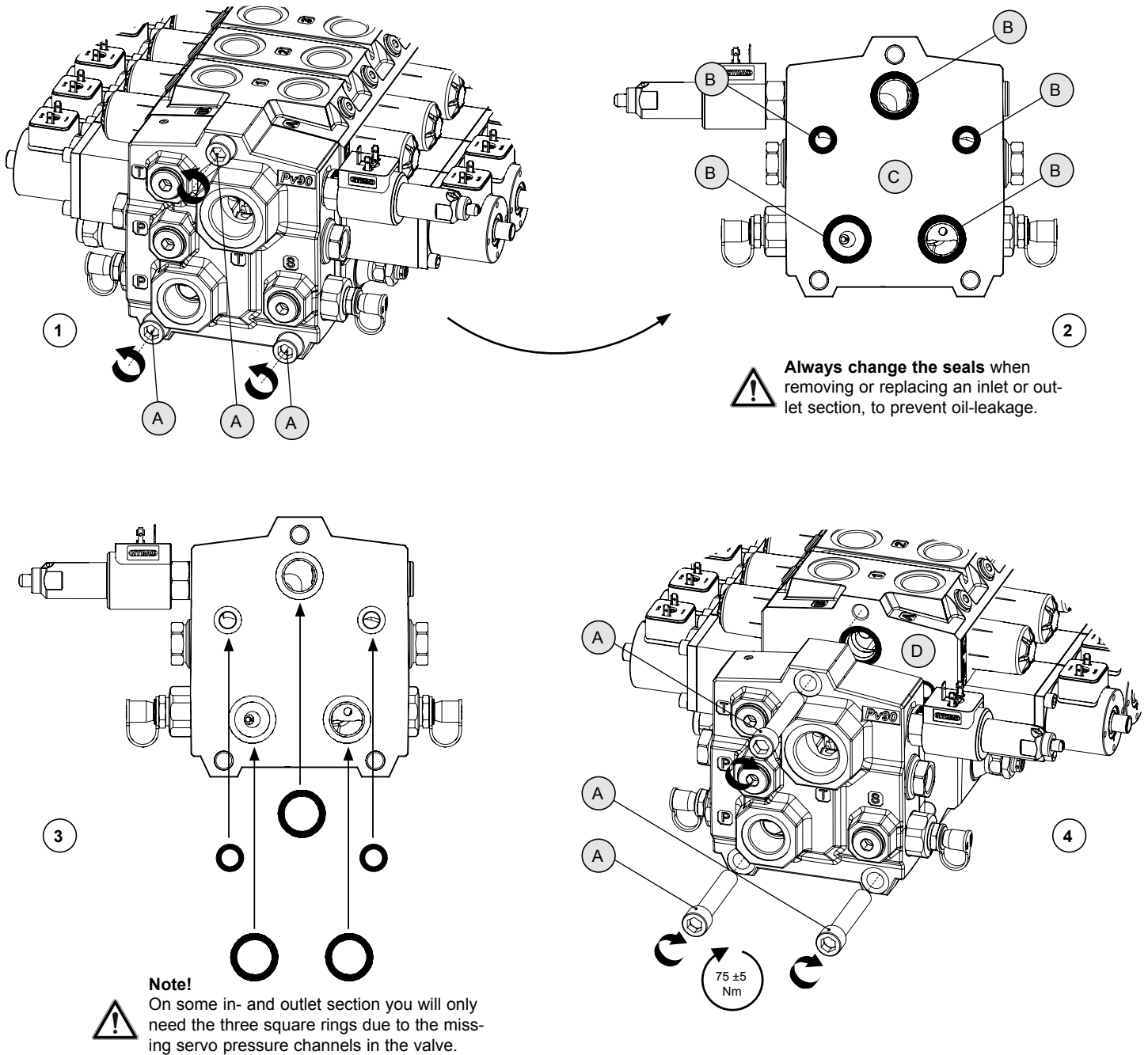

1. Clean up around the area you will be working in to avoid dirt in the components. Unscrew the three M12 bolts (A) using a 10 mm hexagon wrench or equivalent.
2. Remove the old seals (B) and clean the contact area (C), **make sure that there is no dirt or burrs left before reassembling.**
3. Insert the new seals that comes with the seal kit.
4. Clean the contact area on the valve (D), **make sure that there is no dirt or burrs left.** Mount a new or existing inlet- or outlet section and tighten all three M12 bolts (A) easily before tightening them with 75 ± 5 Nm using a 10 mm Allen torque wrench.

Contains

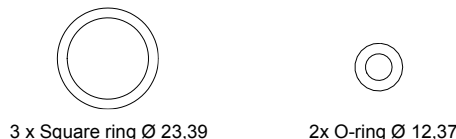

3 x Square ring \varnothing 23,39

2x O-ring \varnothing 12,37

Seal kit in- and outlet section